

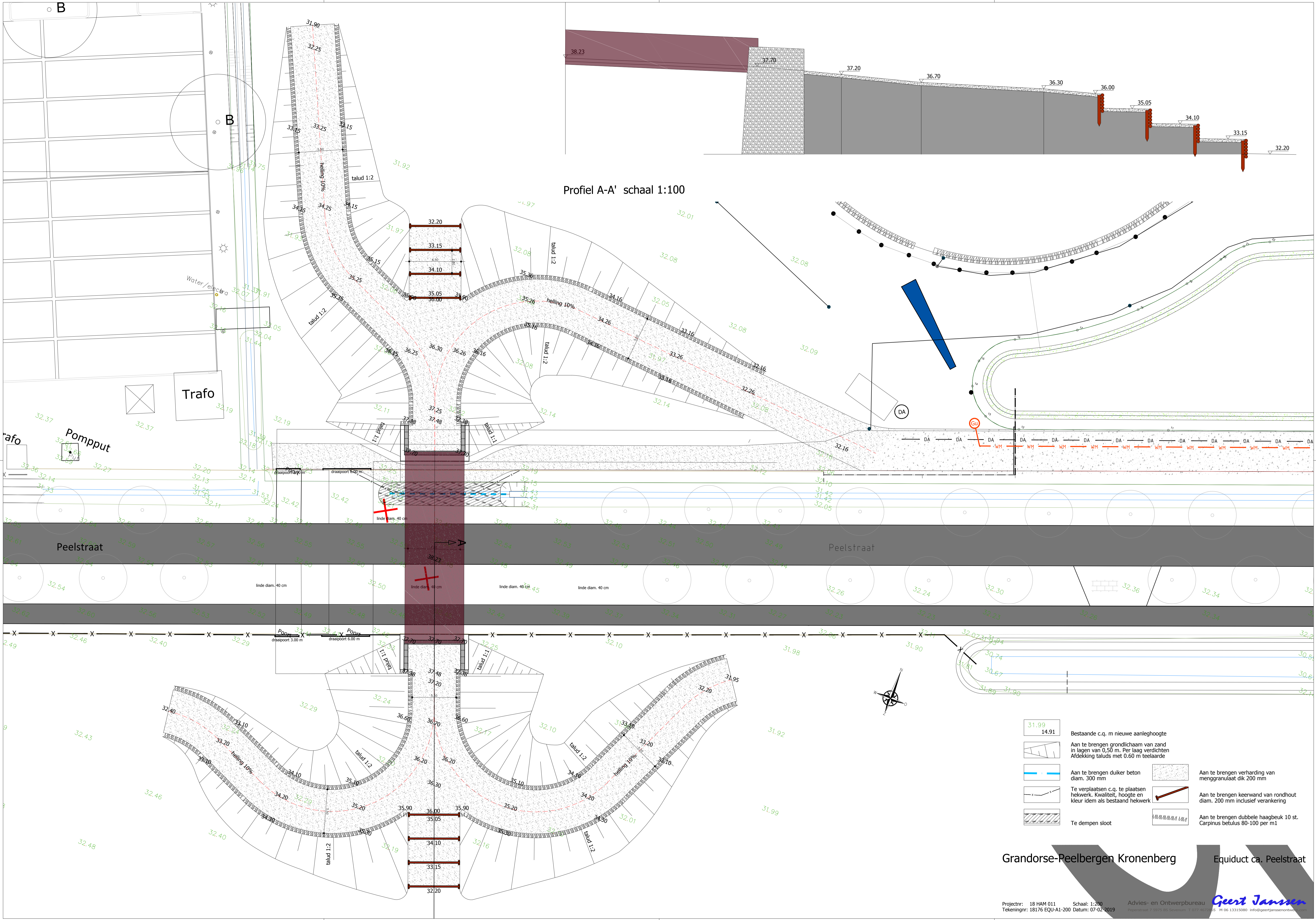

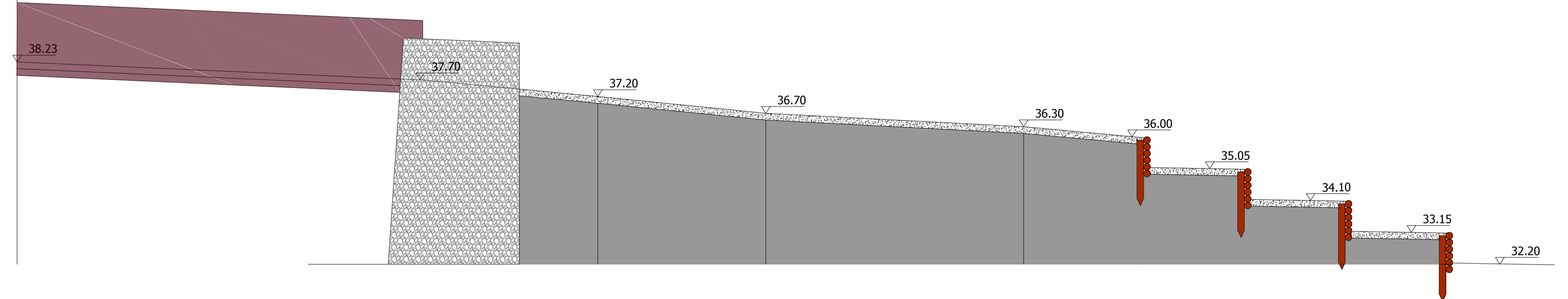

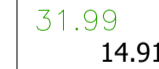

Profiel A-A' schaal 1:100

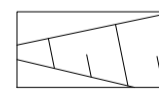

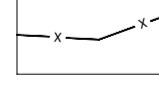
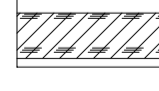
-  Bestaande c.q. m nieuwe aanleghoogte
-  Aan te brengen grondlichaam van zand in lagen van 0,50 m. Per laag verdichten. Afdekking taluds met 0,60 m teelaarde
-  Aan te brengen duiker beton diam. 300 mm
-  Te brengen verharding van menggranulaat dik 200 mm
-  Te verplaatsen c.q. te plaatsen hekwerk. Kwaliteit, hoogte en kleur idem als bestaand hekwerk
-  Aan te brengen keerwand van rondhout diam. 200 mm inclusief verankering
-  Te dempen sloot
-  Aan te brengen dubbele haagbeuk 10 st. Carpinus betulus 80-100 per m1

Grandorse-Peelbergen Kronenberg Equiduct ca. Peelstraat